

Seismic Sealtite 61CR

Pre-compressed Joint Sealant, NSF 61 approved
polysulfide-bellows designed for vertical &
horizontal applications.

PRIMARY USES
Below Grade Applications
Longitudinal/Transverse Joints
Parking Structure Expansion Joints

PRODUCT DESCRIPTION

- Seismic Sealtite 61CR is a premium quality joint sealant composed of an open micro-cell polyurethane foam impregnated with a hydrophobic polymer sealing compound with a factory applied NSF 61, Sec. 6 approved polysulfide coating.
- Developed to perform under extreme conditions such as those found in vertical and horizontal applications including DOT, water treatment and parking structure type expansion joints.
- Provides a watertight, dustproof, airtight, UV stable, chemically resistant, soundproof, and insulated primary seal.
- Seismic Sealtite 61CR works under its own constant internal pressure to provide a permanent, watertight seal eliminating costly water damage, as well as allowing for a greater degree of joint movement.
- Once Seismic Sealtite 61CR is installed in the joint, the material adapts to the width of the joint and the irregularities of the substrate provided such profile changes are not sudden or extreme.
- Developed to meet all applicable standards for compressible sealants.
- Permanently resilient; The material will expand and contract with the movement of the joint under any weather condition.
- Standard Colors: Bronze gray
(color may vary by production lot)
- Available Sizes (Joint Width)
*Sticks: 1/2" to 12"

* (Custom sizes available upon request)

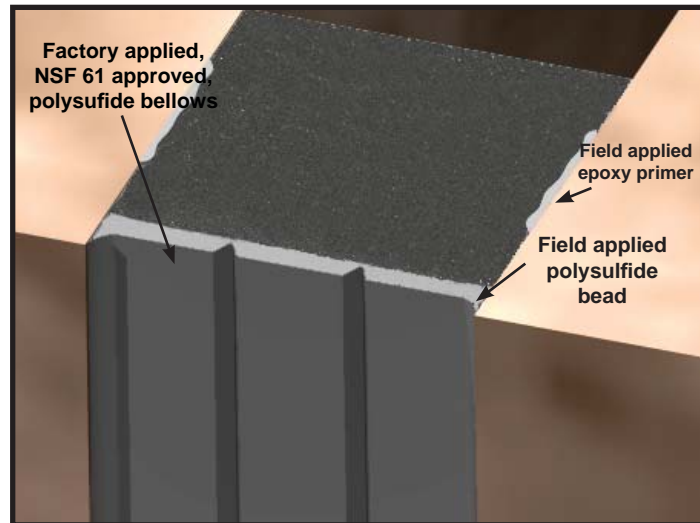

ADVANTAGES

- Can accommodate rapid rates of joint movement
- Made from a monolithic piece of foam that will not delaminate like multi-layer products
- Consistent depth of product
- Used for joints up to 12" wide
- Allows for up to 50% ($\pm 25\%$) movement
- Can be permanently bonded to the joint substrate
- Not based on cheap asphaltic or bitumastic impregnation
- Environmentally safe;
No ChloroFluoroCarbons (CFCs)

PRIMARY APPLICATIONS

- Primary horizontal or vertical joints
- Control joints
- Below grade applications
- Highway longitudinal and transverse joints
- Parking structure expansion joints
- Bridge expansion joints
- Plaza decks
- Pre-cast or retrofit joints
- Other joints requiring a watertight seal

Seismic Sealite 61CR

SPECIFICATION

Sealant shall be Seismic Sealite 61CR as manufactured by Schul International Company, LLC, 800-848-1120. Sealant shall be an open cell foam impregnated with a hydrophobic polymer and NSF approved polysulfide bellows. Seismic Sealite 61CR shall be installed in the joint in a pre-compressible state and shall provide a watertight joint. When compressed to 50% of its fully expanded size, Seismic Sealite 61CR must provide a watertight joint. The manufacturer shall furnish a Certificate of Compliance with these requirements.

TEST DATA

Density		10 lb/cu. ft. (160kg/m ³)
Thermal Conductivity		0.05 W/m.°C
Temperature Stability Range		-40°F (-40°C) to 185°F (85°C)
Tensile Strength	ASTM 3574	21 psi min.
Ultimate Elongation	ASTM 3574	125% ±20%
Resistance to Compression Set		Max 2.5%
Shear Strength		Min 8N/cm ²
Mildew Resistance		Excellent
Staining		None
Flammability	UL 94VO	Self Extinguishing
Flash Point	Meets CAL 117	590°F (310°C)
Durometer Hardness	ASTM D2240	Shore A 15pts.

LIMITATIONS

- Joints must be sized by measuring every 5-7ft. (1.524 – 2.137 meters) to ensure gap opening is uniform and depth is sufficient for the supplied material.
- If ambient storage temperatures are below 50°F (10°C), store material at a minimum of 68°F (20°C) for a minimum of 24 hours prior to installation, regardless of temperature at location of installation.
- Store material in a dry, enclosed area, off the ground, and out of direct sunlight. Do not install when raining or snowing.
- Do not install when substrate or ambient temperatures are below -14°F (-25°C) or above 95°F (35°C).
- Will not adhere to surfaces contaminated by oil or grease.
- For specific chemical resistant properties contact Schul technical support.

NOT INTENDED FOR

- Joints > than 5' head pressure (2.16psi)
- Joints in contact with harsh chemicals
- Joints in roofing applications
- Joints requiring pick resistance
- Cross joints in copings and projecting stone work

WARRANTY

Subject to certain limitations Schul warrants Seismic Sealite 61CR against defects in material for a period of five (5) years from the date of delivery, provided Schul limitations and project specific recommendations were followed.

INSTALLATION

PREPARATION

- Verify that the joint is clean, sound, and will provide an appropriate surface for installation of the joint sealant.
- Check material for the appropriate lengths, widths, and depths.
- Prepare the material for seams and proper lengths.

INSTALLATION

- Run a ¼" bead of the supplied epoxy adhesive along both sides of the joint approximately ½" – ¾" back from the substrate surface.
- Release Seismic Sealite 61 CR from packaging and insert the material into the joint.
- Tool the supplied polysulfide over all seams, and transitions. Run a sealant bead along both edges of the joint and mask the concrete face to allow for a clean, aesthetic finish.

CLEAN UP

- Remove any excess epoxy left on the surface of the material or substrate.
- Remove all waste materials from the jobsite.
- Do not reuse waste material.
- Leave site to the satisfaction of the owner/architect.



International Quality Registrars Corp.
Quality System Registration



MGM.T.SYS.
RVA 0073
The Dutch Accreditation Council



Approvals
Quality System Registration

ISO 9001: 2008 Certified

For complete installation instructions and product information, contact [Technical Support: 800.848.1120](tel:800.848.1120) or visit us on the web at www.sealiteusa.com

Schul International Co., LLC ("the company") will refund the price of or replace, at its election, any product which it finds to be defective, provided the product has been properly used. Except as expressly stated above, the company does not make any warranty, expressed or implied, of any nature whatsoever with respect to the product or the use thereof. In no event shall the company be liable for delay caused by defects, for loss of material, for indirect, special or consequential damages, or for any charges or expenses of any nature incurred without its written consent. The foregoing is the full extent of the responsibility of the company even though the company may have been negligent.

SCHUL INTERNATIONAL COMPANY, LLC ONE INDUSTRIAL DRIVE, PELHAM, NH 03076
TELEPHONE: 800.848.1120 • FAX: 800.998.9105 • WEB ADDRESS: www.sealiteusa.com