

Sealtite™ VP

Pre-compressed Joint Sealant,
High Density, Polyurethane Foam,
Vapor Permeable Applications.

PRIMARY USES
Primary Construction Joints
Vertical/Horizontal Movement Joints
Exterior Panel Systems

PRODUCT DESCRIPTION

- Sealtite™ VP is a premium quality joint sealant composed of a high density, open micro-cell polyurethane foam impregnated with a hydrophobic, flame retardant, modified acrylic.
 - Developed as a premium quality “breathable” joint sealant that can withstand driving rain to 12psf (69mph wind) while still allowing an escape for moisture trapped inside cavity walls.
 - Provides a watertight (600Pa), vapor permeable, UV stable, chemically resistant, soundproof, and insulated urethane primary seal.
 - Works under its own constant internal pressure to provide a permanent, watertight seal eliminating costly water damage, as well as allowing for a greater degree of joint movement.
 - Once Sealtite™ VP is installed in the joint, the material expands depending on temperature, adapting to the width of the joint and the irregularities of the substrate provided such profile changes are not sudden or extreme.
 - Developed to meet all applicable standards for pre-compressed sealants.
 - Permanently resilient; The material will expand and contract with the movement of the joint under any weather condition.
 - Standard Colors: Black and Concrete Gray
 - Available Sizes (Joint Width)
 - Rolls: 1/8” to 2”
 - *Sticks: 1-3/4” to 8”
- *(Custom sizes available upon request)

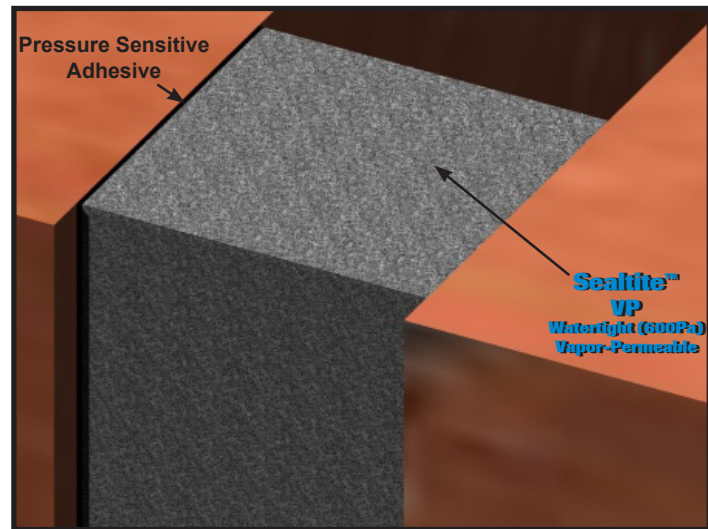

ADVANTAGES

- Can accommodate rapid rates of joint movement
- Supplied in pre-compressed state for ease of installation
- Excellent compression recovery
- Permanently elastic and weather-tight
- Resists stretching and twisting during installation due to the Polyester scrim in the PSA (Pressure Sensitive Adhesive)
- Used for joints up to 8” wide
- Allows for up to 100% (±50%) movement
- Consistent depth of product
- Not based on asphaltic or bitumastic impregnation
- Paintable with water-based paints

PRIMARY APPLICATIONS

- Primary construction joints
- Secondary construction joints – Behind caulk w/ backer rod (or specify Sealtite B)
- Vertical or horizontal movement – Expansion, control, and isolation joints
- Retrofit joints
- Pre-cast concrete walls – Tilt-up walls
- Exterior Panel Systems – Masonry, granite, metal, EIFS, and curtain walls
- Interior vapor, dust, acoustical and air control
- Other joints requiring a watertight seal

“Sealtite™ VP is ideal for cavity walls and areas subject to moisture and condensation build-up. The difference between inside and outside temperatures, and humidity, create a dew point where condensation will develop within the building envelope. When condensation develops within a building envelope that has no open vapor permeable passages (frozen weep holes, etc.), moisture can build up within the wall system resulting in mold, mildew and water infiltration of the interior of the building envelope.” - Kubal, M.T., “Waterproofing the Building Envelope”, McGraw-Hill, 1993, pp.4

Sealtite™ VP

SPECIFICATION

Sealant shall be Sealtite™ VP as manufactured by Schul International Company, LLC, 800-848-1120. Sealant shall be a high density, open micro-cell polyurethane foam impregnated with a flame retardant modified acrylic that meets ASTM 518, ASTM 283, and DIN 18542. Sealtite™ VP shall be installed in the joint in a pre-compressed state. When compressed to (25%) of its fully expanded size, Sealtite™ VP must provide a vapor permeable, watertight joint that meets ASTM E331 and ASTM E547 (12 psf). The manufacturer shall furnish a Certificate of Compliance with these requirements.

TEST DATA

Thermal Resistance	ASTM C518	3.3 hr-°F-ft²/Btu
UV Resistance		Excellent
Density		10 lb/cu. ft. (160kg/m³)
Temperature Stability Range		-40°F to 212°F
Resistance to Compression	ASTM 3574	Max 2.5%
Set		
Shear Strength		Min. 8N/cm²
Thermal Conductivity		0.05W/m. °C
Tensile Strength	ASTM 3574	Meets 21 psi min.
Ultimate Elongation	ASTM 3574	125% ±20%
Mildew Resistance		Excellent
Flammability	UL 94VO	Self Extinguishing
	ASTM E84	Flame Spread 0
Flash Point		590°F (310°C)
Water Resistance	ASTM E331	12 psf
	ASTM E547	12 psf

LIMITATIONS

- Joints must be sized by measuring every 5-7ft. (1.524 – 2.137 meters) to ensure gap opening is uniform and depth is sufficient for the supplied material.
- Do not install when substrate or ambient temperatures are below -14°F (-25°C) or above 95°F (35°C).
- Will not adhere to surfaces contaminated by oil or grease.
- If ambient storage temperatures are below 50°F (10°C), store material at a minimum of 68°F (20°C) for a minimum of 24 hours prior to installation, regardless of temperature at location of installation.
- Store material in a dry, enclosed area, off the ground, and out of direct sunlight. Do not install when raining or snowing.

NOT INTENDED FOR

- Joints submerged in water
- Joints in contact with harsh chemicals
- Joints in roofing applications
- Joints requiring pick resistance
- Cross joints in copings and projecting stone work

WARRANTY

Subject to certain limitations Schul warrants Sealtite VP Expansion Joint against defects in material for a period of ten (10) years from the date of delivery, provided Schul limitations and project specific recommendations were followed.

INSTALLATION

PREPARATION

- Verify that the joint is clean, sound, and will provide an appropriate surface for installation of the joint sealant.
- Check material for the appropriate lengths, widths, and depths.
- Do not un-wrap the material until ready for installation into the joint because the packaging maintains material in compression.

ROLL INSTALLATION

- When fully prepared to install, remove the outer lining surrounding the roll and the first 1"-2" of material.
- Insert the material into the joint while pressing the material against the side of the joint activating the PSA (Pressure Sensitive Adhesive).

STICK INSTALLATION

- When fully prepared to install, open the sealant material by removing the shrink packaging and masonite strapping.
- Remove the white release liner on both sides of the material.
- Insert the material into the joint while pressing the material against the side of the joint.

CLEAN UP

- Remove all waste materials from the jobsite.
- Do not reuse waste material.
- Leave site to the satisfaction of the owner/architect.



International Quality Registrars Corp.
Quality System Registration



MGMT. SYS.
RvA C073
The Dutch Accreditation Council



FM
Approvals
Quality System Registration

ISO 9001: 2000 Certified

For complete installation instructions and product information, contact [Technical Support: 800.848.1120](tel:800.848.1120) or visit us on the web at www.sealtiteusa.com

Schul International Co., LLC ("the company") will refund the price of or replace, at its election, any product which it finds to be defective, provided the product has been properly used. Except as expressly stated above, the company does not make any warranty, expressed or implied, of any nature whatsoever with respect to the product or the use thereof. In no event shall the company be liable for delay caused by defects, for loss of material, for indirect, special or consequential damages, or for any charges or expenses of any nature incurred without its written consent. The foregoing is the full extent of the responsibility of the company even though the company may have been negligent.

SCHUL INTERNATIONAL COMPANY, LLC ONE INDUSTRIAL DRIVE, PELHAM, NH 03076

TELEPHONE: 800.848.1120 • FAX: 800.998.9105 • WEB ADDRESS: www.sealtiteusa.com