

Sealtite™ AirStop

**Pre-compressed Joint Sealant,
High Density, Polyurethane Foam,
Air and Sound Infiltration Barrier.**

PRIMARY USES
Stationary or Moving Joints
Structural Space Between
Window and Door Frames

PRODUCT DESCRIPTION

- Sealtite™ AirStop is a premium quality joint sealant composed of a high density, 80% open micro-cell polyurethane foam impregnated with a hydrophobic, flame retardant, modified acrylic.
- Developed as a premium quality joint sealant designed to provide sound control characteristics in a wide range of applications
- Provides a dustproof, airtight, soundproof, and insulated urethane seal.
- Works under its own constant internal pressure to provide a permanent seal ideal for use as an air infiltration barrier in stationary or moving joints, as well as allowing for a greater degree of joint movement.
- Once Sealtite™ AirStop is installed in the joint, the material expands depending on temperature, adapting to the width of the joint and the irregularities of the substrate provided such profile changes are not sudden or extreme.
- Developed to meet all applicable standards for pre-compressed sealants.
- Permanently resilient; The material will expand and contract with the movement of the joint under any weather condition.
- Can be coated with a neoprene coating for use in high wear or exposed applications.
- Sound joints with 100% movement capabilities may be constructed by gluing Sealtite™ AirStop to both side walls of a joint.
- Standard Colors: Black and Concrete Gray
- Available Sizes (Joint Width)
*Rolls: 3/8" to 5"
*(Custom sizes available upon request)

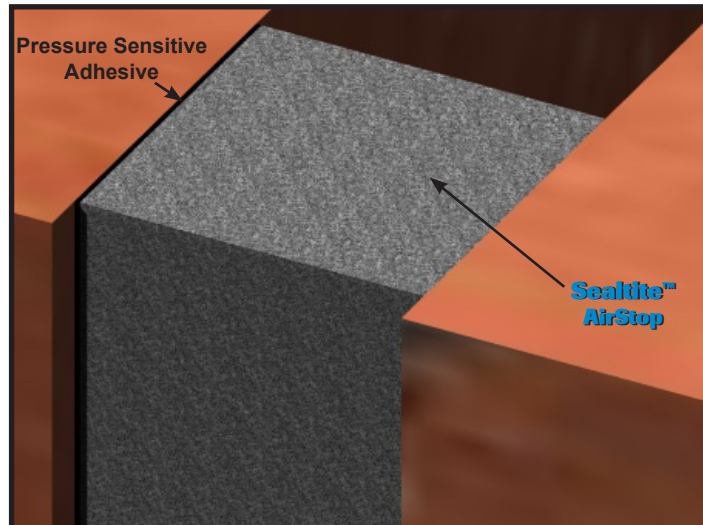

ADVANTAGES

- Supplied in pre-compressed state for ease of installation
- Excellent compression recovery
- Permanently elastic and weather-tight
- Resists stretching and twisting during installation due to the Polyester scrim in the PSA (Pressure Sensitive Adhesive)
- Used for joints up to 5" wide
- Allows for up to 100% (±50%) movement
- Consistent depth of product
- Not based on asphaltic or bitumastic impregnation
- Paintable with water-based paints
- Compressible to 10% of original thickness when compressed in one dimension

PRIMARY APPLICATIONS

- Stationary or moving joints
- Curtain walls
- Masonry stud plates
- Concrete slabs
- Structural space between window and door frames
- Partition walls with ceilings
- Seams between chimneys, roof protection, roof panels, and wall panels
- Through penetrations, around cables and pipes
- Air sealing
- Other joints requiring an air infiltration barrier

Sealtite™ AirStop

SPECIFICATION

Sealant shall be Sealtite™ AirStop as manufactured by Schul International Company, LLC, 800-848-1120. Sealant shall be a cross-linked, high density, open micro-cell polyurethane foam of not less than 1.84 lb. per cubic foot density. Sealtite™ AirStop shall meet California Fire Code including modifications (CAL 117) and UL94-VO. The manufacturer shall furnish a Certificate of Compliance with these requirements.

TEST DATA

| | | |
|---------------------------------|---------------------|--------------------------------------|
| Thermal Resistance | ASTM C518 | 3.3 hr-°F-ft ³ /Btu |
| UV Resistance | | Excellent |
| Temperature Stability Range | | -40°F to 212°F |
| Resistance to Compression | ASTM 3574 | Max 2.5% |
| Set | | |
| Shear Strength | | Min. 8N/cm ² |
| Thermal Conductivity | | 0.05W/m. °C |
| Mildew Resistance | | Excellent |
| Flammability | UL 94VO ASTM E84 | Self Extinguishing Flame Spread 0 |
| Flash Point | | 590°F (310°C) |
| Elongation | | 325% |
| Tensile Strength | | 53psi. |
| Reduction in Noise/Transference | | 25 dB |

LIMITATIONS

- Joints must be sized by measuring every 5-7ft. (1.524 – 2.137 meters) to ensure gap opening is uniform and depth is sufficient for the supplied material.
- Do not install when substrate or ambient temperatures are below -14°F (-25°C) or above 95°F (35°C).
- Will not adhere to surfaces contaminated by oil or grease.
- If ambient storage temperatures are below 50°F (10°C), store material at a minimum of 68°F (20°C) for a minimum of 24 hours prior to installation, regardless of temperature at location of installation.
- Store material in a dry, enclosed area, off the ground, and out of direct sunlight. Do not install when raining or snowing.

NOT INTENDED FOR

- Joints submerged in water
- Joints in contact with harsh chemicals
- Joints in roofing applications
- Joints requiring pick resistance
- Cross joints in copings and projecting stone work

WARRANTY

Subject to certain limitations Schul warrants Sealtite AirStop Expansion Joint against defects in material for a period of ten (10) years from the date of delivery, provided Schul limitations and project specific recommendations were followed.

INSTALLATION

PREPARATION

- Verify that the joint is clean, sound, and will provide an appropriate surface for installation of the joint sealant.
- Check material for the appropriate lengths, widths, and depths
- Do not un-wrap the material until ready for installation into the joint because the packaging maintains material in compression.

ROLL INSTALLATION

- When fully prepared to install, remove the outer lining surrounding the roll and the first 1"-2" of material.
- Insert the material into the joint while pressing the material to the side of the joint activating the PSA (Pressure Sensitive Adhesive).

CLEAN UP

- Remove all waste materials from the jobsite.
- Do not reuse waste material.
- Leave site to the satisfaction of the owner/architect.



ISO 9001: 2000 Certified

For complete installation instructions and product information, contact [Technical Support: 800.848.1120](tel:800.848.1120) or visit us on the web at www.sealtiteusa.com

Schul International Co., LLC ("the company") will refund the price of or replace, at its election, any product which it finds to be defective, provided the product has been properly used. Except as expressly stated above, the company does not make any warranty, expressed or implied, of any nature whatsoever with respect to the product or the use thereof. In no event shall the company be liable for delay caused by defects, for loss of material, for indirect, special or consequential damages, or for any charges or expenses of any nature incurred without its written consent. The foregoing is the full extent of the responsibility of the company even though the company may have been negligent.

SCHUL INTERNATIONAL COMPANY, LLC ONE INDUSTRIAL DRIVE, PELHAM, NH 03076

TELEPHONE: 800.848.1120 • FAX: 800.998.9105 • WEB ADDRESS: www.sealtiteusa.com